



RL2-650(2V650Ah)

Specification

Cells Per Unit	1
Voltage Per Unit	2
Nominal Capacity	650Ah@10hour-rate to 1.80V per cell @25°C
Weight	Approx. 40 Kg (Tolerance ±2%)
Internal Resistance	Approx. 0.6 mΩ
Terminal	F10(M8)
Max. Discharge Current	3250A (5 sec)
Short Circuit Current	5200A
Design Life	20 years (Float charging)
Recommended Maximum Charging Current	130 A
Reference Capacity	C1 401.5AH C3 504.0AH C5 568.5AH C10 650.0AH
Standby Use Voltage	2.27 V~2.30 V @ 25°C Temperature Compensation: -3mV/°C/Cell
Cycle Use Voltage	2.43 V~2.47 V @ 25°C Temperature Compensation: -4mV/°C/Cell
Operating Temperature Range	Discharge: -20°C~60°C Charge: 0°C~50°C Storage: -20°C~60°C
Normal Operating Temperature Range	25°C±5°C
Self Discharge	RITAR Valve Regulated Lead Acid (VRLA) batteries can be stored for up to 6 months at 25°C and then recharging is recommended. Monthly Self-discharge ratio is less than 3% at 25°C. Please charge batteries before using.
Container Material	A.B.S. UL94-HB, UL94-V0 Optional.



RL series is a general purpose battery with 20 years design life in float service. It meets with heavy duty grids, thicker plates, special additives and advanced AGM valve regulated technology, the RL series battery provides consistent performance and long service life. The new grid design effectively reduces the internal resistance, which provides higher specific energy density and excellent high rate discharge characteristics. It is suitable for communications back-up power and EPS/UPS applications.



Dimensions

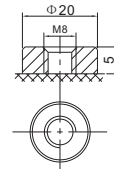
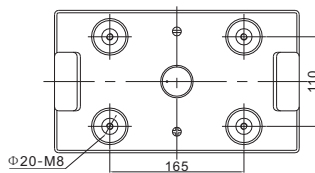
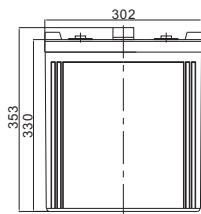

F10 TERMINAL

Length	302±2mm (11.9 inches)
Width	175±2mm (6.89 inches)
Height	330±2mm (13.0 inches)
Total Height	353±2mm (13.9 inches)
Terminal	Value
M5	6~7 N*m
M6	8~10 N*m
M8	10~12 N*m

Unit: mm

Constant Current Discharge Characteristics : A (25°C)

F.V/Time	15MIN	30MIN	1HR	2HR	3HR	4HR	5HR	8HR	10HR
1.60V	1020	641.5	401.5	242.9	177.7	143.2	119.4	82.3	69.2
1.65V	993.5	627.4	394.1	239.3	175.3	141.4	118.0	81.5	68.6
1.70V	958.4	608.8	384.2	234.6	172.2	139.0	116.2	80.4	67.7
1.75V	912.6	584.4	371.3	228.3	168.0	135.9	113.7	78.9	66.6
1.80V	853.8	552.8	354.4	220.1	162.5	131.7	110.5	77.0	65.0
1.85V	779.5	512.4	332.6	209.4	155.3	126.3	106.3	74.4	63.0

Constant Power Discharge Characteristics : WPC (25°C)

F.V/Time	15MIN	30MIN	1HR	2HR	3HR	4HR	5HR	8HR	10HR
1.60V	1853	1199	761.0	463.9	341.1	276.0	233.2	161.9	136.4
1.65V	1831	1185	752.4	459.9	338.4	273.9	231.2	160.6	135.3
1.70V	1777	1154	735.8	451.9	333.0	269.9	227.9	158.5	133.7
1.75V	1709	1114	714.3	441.7	326.2	264.7	223.5	155.8	131.6
1.80V	1615	1058	685.2	427.5	316.7	257.6	217.7	152.1	128.7
1.85V	1489	988.2	646.6	408.5	303.8	247.8	209.8	147.3	124.8

(Note) The above characteristics data are average values obtained within three charge/discharge cycle not the minimum values.

RL2-650(2V650Ah)



Discharge Characteristics Curve

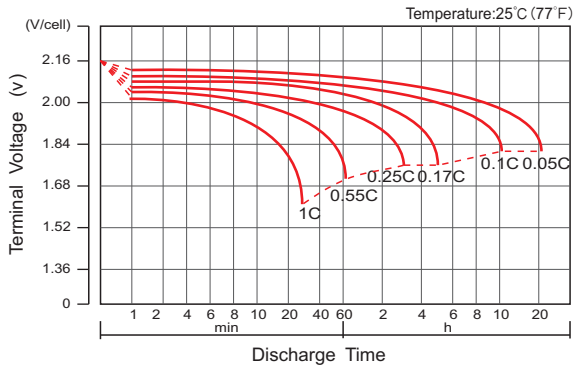

Charge Characteristic Curve For Standby Use

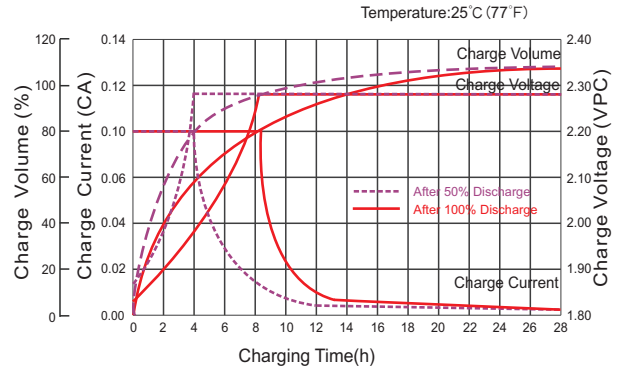

Cycle Life In Relation To Depth Of Discharge

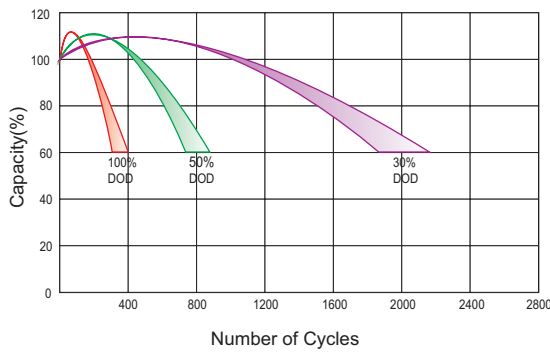

Relationship Between Charging Voltage And Temperature

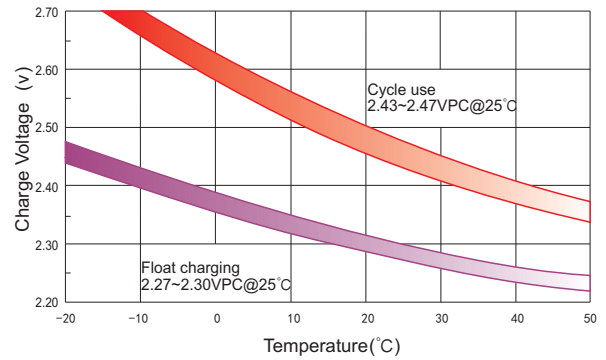

Temperature Effects On Capacity

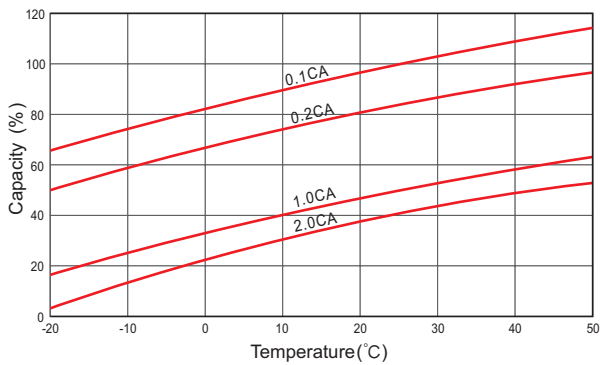

Storage Characteristics

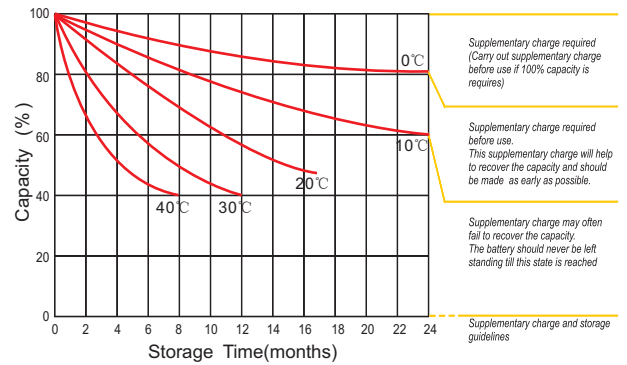

Effect Of Temperature On Long Term Life

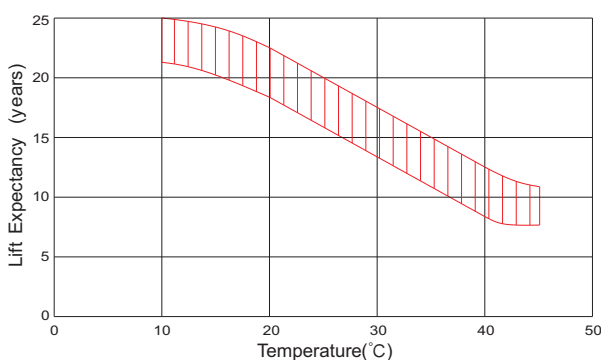

Life Characteristics Of Standby Use

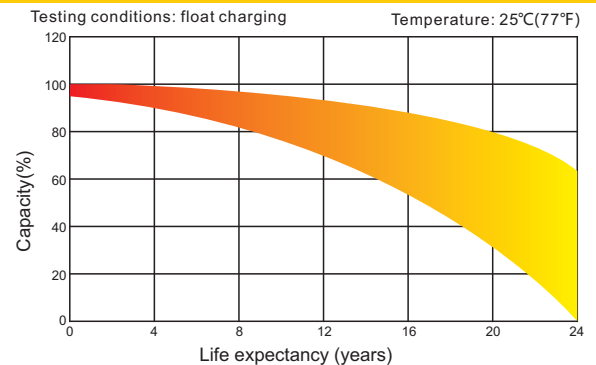

(Note) All above information shall be changed without prior notice, Ritar reserves the right to explain and update the latest information.